

ROUND

CONTEMPORARY KITCHEN



ROUND

CONTENTS



ROUND 01

ROVERE MOGANO
BIANCO LUCIDO
GRIGIO FUMO

p. 4-13



ROUND 02

BIANCO SETA
TERRA

p. 14-23



ROUND 03

PERLA
SABBIA
GRIGIO FUMO

p. 24-33



ROUND 04

CRETA
ROCCIA
OCRA

p. 34-43



ROUND 05

VISONE
ROVERE CORTECCIA
BISCOTTO

p. 44-53

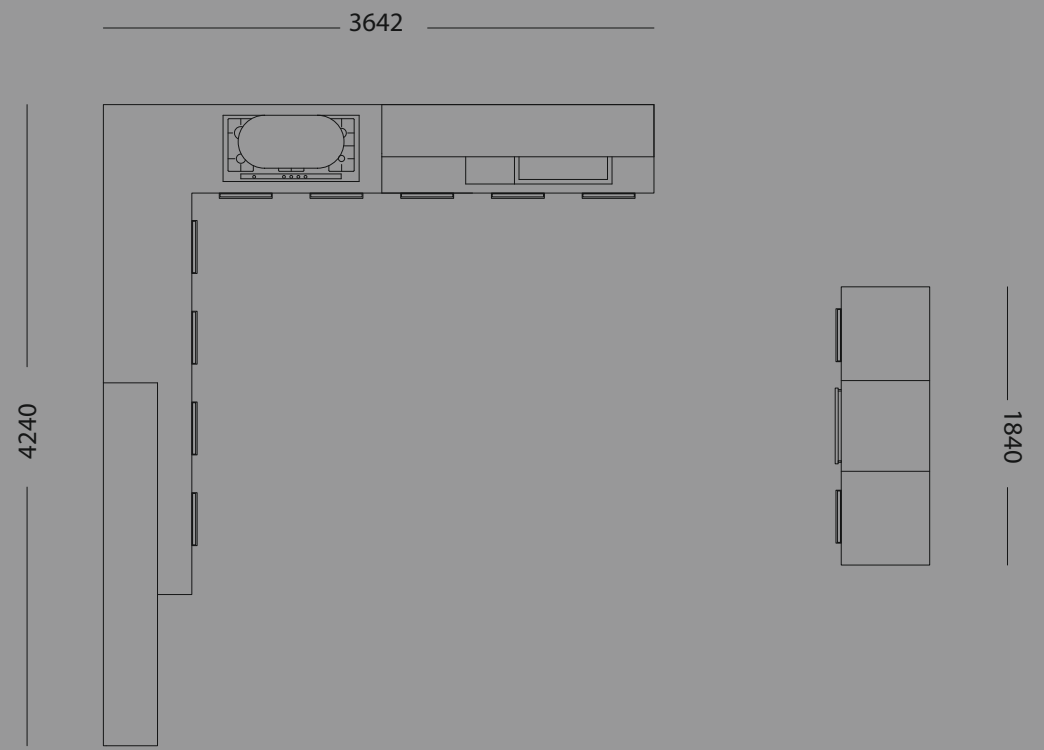

ROVERE MOGANO
BIANCO LUCIDO
GRIGIO FUMO

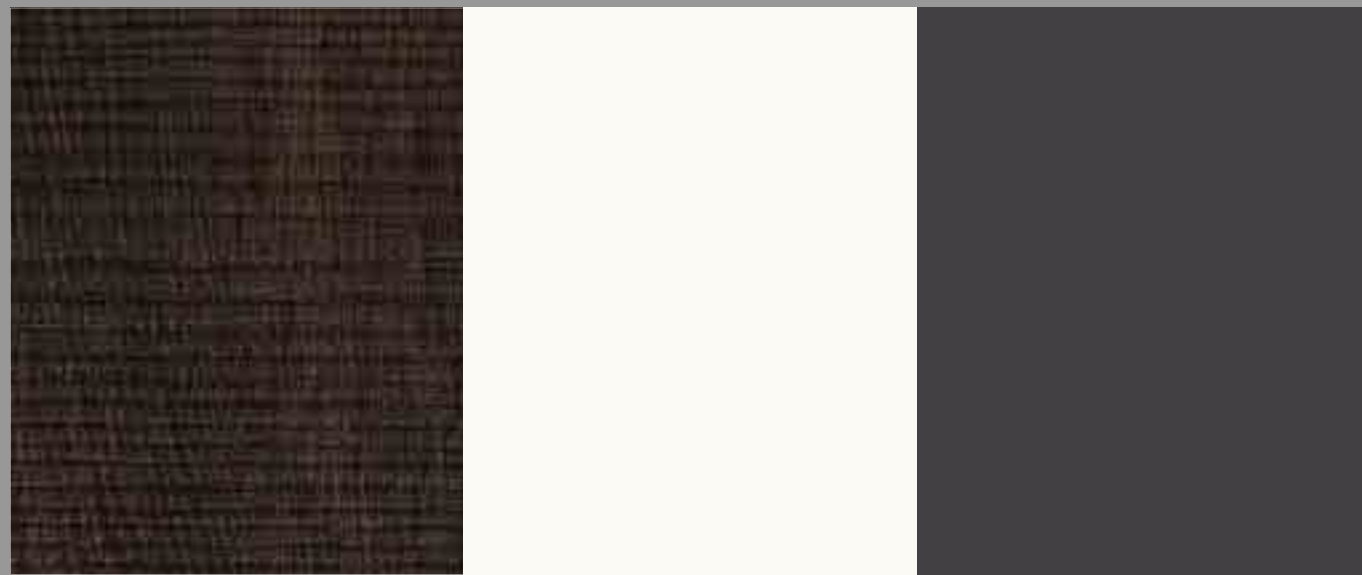

ROUND 01

L'ACCOSTAMENTO A CONTRASTO DEL ROVERE MOGANO E DEL POLIMERICO BIANCO LUCIDO RENDE FORTEMENTE CONTEMPORANEA QUESTA COMPOSIZIONE, IMPREZIOSITA DA DETTAGLI ELEGANTI COME I VANI A GIORNO GRIGIO FUMO, LE MANIGLIE E GLI ZOCCOLI BRUNITI.

A CONTRASTING COMBINATION OF ROVERE CORTECCIA AND GLOSS WHITE POLYMER LAMINATE MAKES THIS COMPOSITION HIGHLY CONTEMPORARY. IT IS EMBELLISHED WITH ELEGANT DETAILS SUCH AS GRIGIO FUMO OPEN UNITS AND BURNTISHED HANDLES AND PLINTHS.





La diversità materica e cromatica messa in scena da basi e pensili, fa risaltare la boisérie e l'elemento terminale a giorno, moduli che caratterizzano l'ambiente cucina. Maniglie in finitura brunita.

The different materials and colours introduced in base units and wall units highlight the wall panel and open end unit, giving the kitchen environment much contemporary appeal. Handles with burnished finish.





Particolare attenzione viene riservata alla zona operativa realizzata in laminato speciale 146, che grazie ad un cambio di spessore, separa il piano cottura dal lavello, sottolineandone le diverse funzioni.

Meticulous attention is given to the functional area in special laminate 146, which, thanks to a change in thickness, separates the hob from the sink, emphasising its various functions.

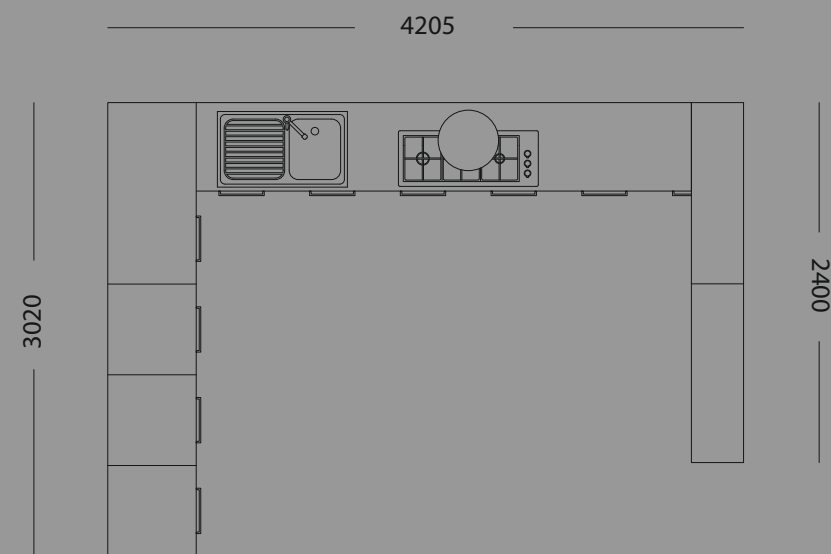

BIANCO SETA
TERRA

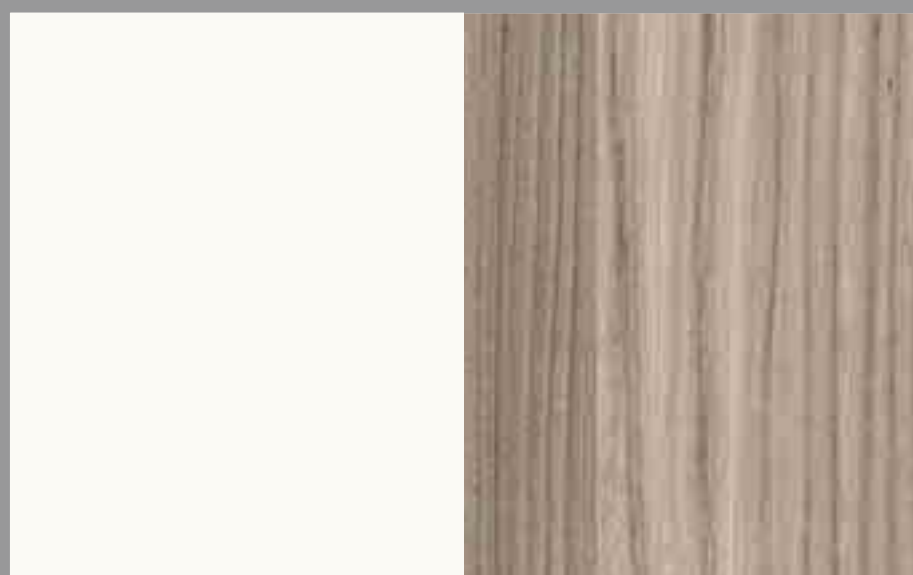

ROUND 02

GEOMETRICO E RIGOROSO, ELEGANTE E RAFFINATO: QUESTO PROGETTO ABBINA LA MATERICITÀ DEL POROREGISTRO IN FINITURA TERRA AL BIANCO, CHE RICORRE SIA IN FINITURA SETA PER BASI E COLONNE, SIA IN CAMEO WHITE PER IL PIANO DI LAVORO INTERAMENTE REALIZZATO IN CORIAN.

GEOMETRIC AND RIGOROUS, ELEGANT AND REFINED: THIS DESIGN PROJECT COMBINES THE MATERIAL QUALITY OF THE TERRA REGISTER PORE FINISH WITH A GLOSS WHITE POLYMER LAMINATE FINISH FOR BASE UNITS AND TALL UNITS, AND A CAMEO WHITE FINISH FOR THE WORKTOP MADE ENTIRELY OF CORIAN.





Il contenimento è ampio e garantito da un'intera parete a colonne. Il bianco è ripetuto su ante, maniglie e zoccoli ad ottenere un effetto total white. Nel dettaglio, pannello con mensole in finitura poro registro terra.

Ample storage space is ensured with a whole wall system of tall units, where the polymer laminate of its doors and the lacquer of its handles and plinths introduce a single colour: total white.





Elementi a giorno in finitura poro registro terra in appoggio alle basi, piano di lavoro in corian cameo white.

Panel and shelves with terra brown register pore finish combined with a cameo white Corian worktop.

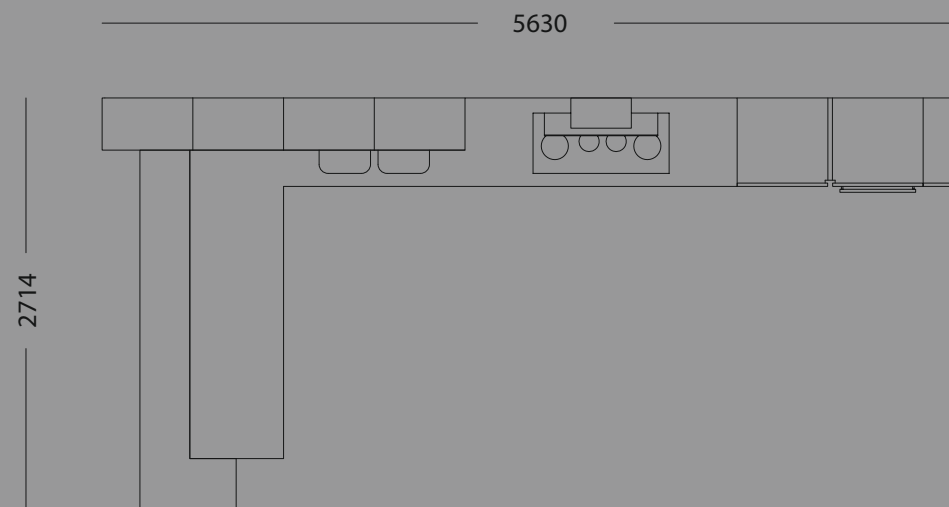

PERLA
SABBIA
GRIGIO FUMO



ROUND 03

COMPOSIZIONE LINEARE DOTATA DI PENISOLA-SNACK. DETERMINANTE IL RUOLO DEL COLORE, CHE ABBINANDO PERLA E SABBIA ALLA FINITURA GRIGIO FUMO, CONFERISCE UN CARATTERE AUTOREVOLE ALL'INSIEME.

A LINEAR COMPOSITION WITH A BREAKFAST BAR/SNACK TOP. COLOUR PLAYS AN ESSENTIAL ROLE, COMBINING PERLA AND SABBIA WITH A GRIGIO FUMO FINISH FOR A STRIKING OVERALL EFFECT.





L'area snack si sviluppa in continuità lineare con la penisola e presenta due basi contenitive a profondità ridotta. Questa soluzione progettuale lascia totalmente libera l'area lavoro della penisola. Elementi a giorno in finitura grigio fumo, pensili in poro registro sabbia.

The snack top extends in a continuous line with the breakfast bar. It has two storage base units with reduced depth. This design solution leaves the work area of the breakfast bar completely free. Open units with grigio fumo finish and wall units with sabbia register pore finish.





Piano lavoro in laminato 145, gola inox, base perla.

A laminated 145 worktop, stainless steel grip-recess and perla base unit.

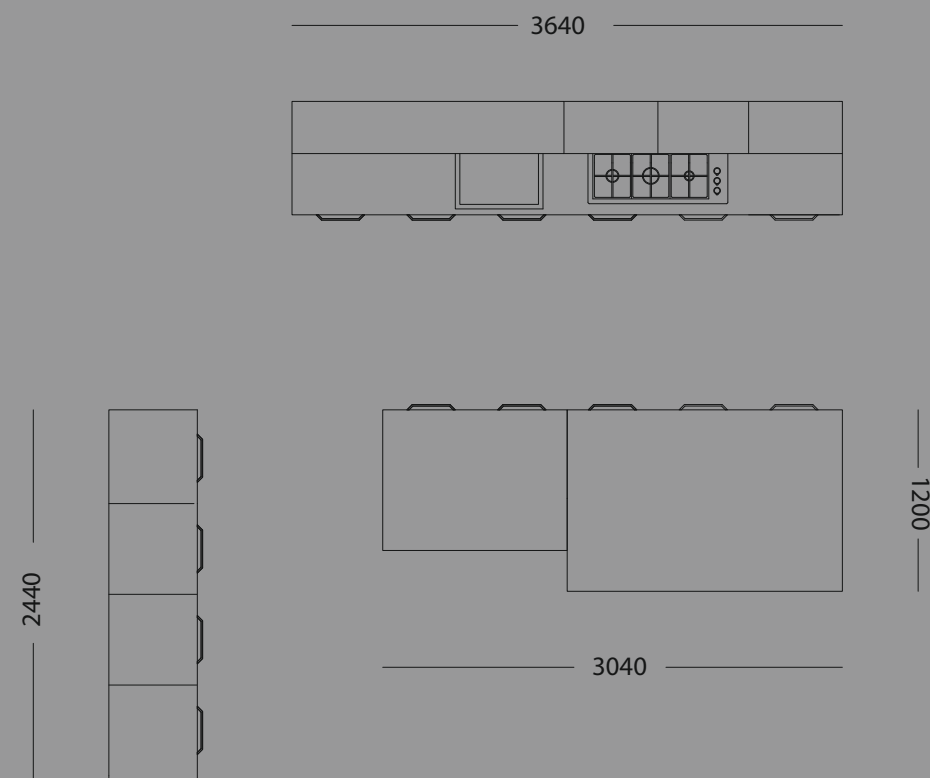

CRETA
ROCCIA
OCRA

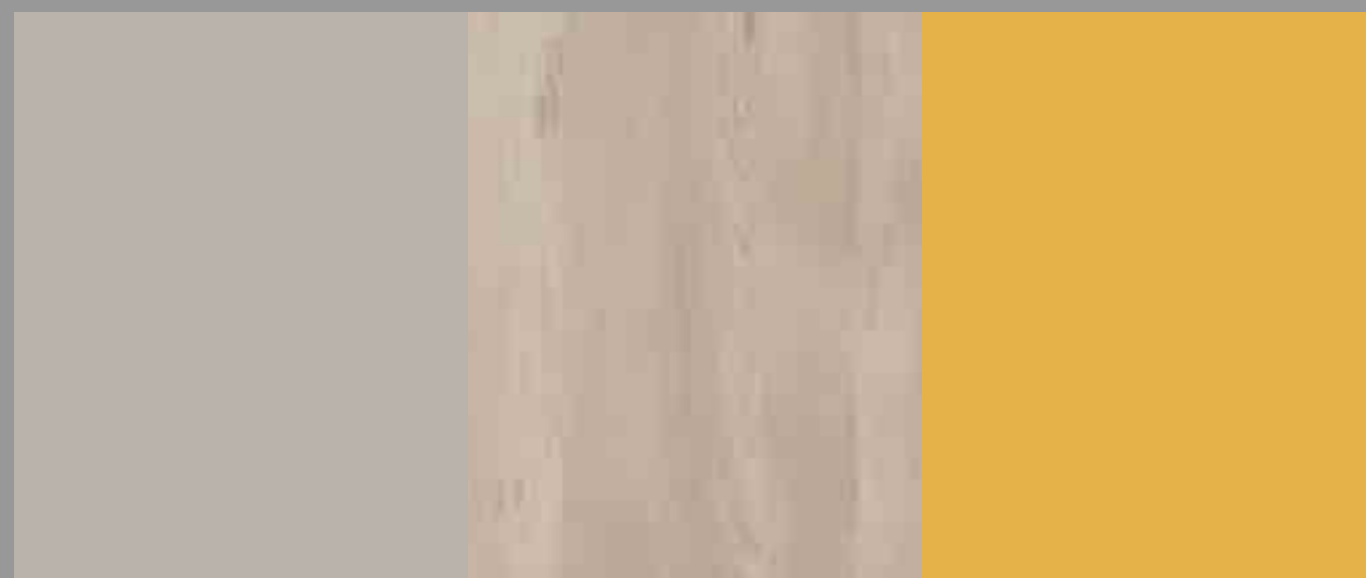

ROUND 04

RICHIAMO ALLA NATURALITÀ DEI MATERIALI ATTRAVERSO LA FINITURA ROCCIA E IL LAMINATO SPECIALE 787. L'ALTERNANZA TRA PIENI E VUOTI, REALIZZATA ATTRAVERSO L'ACCOSTAMENTO DI BASI CONTENITIVE ED ELEMENTI A GIORNO, È SOTTOLINEATA DALL'USO DEL COLORE, CHE DONA FRESCHEZZA E VIVACITÀ ALL'INTERO AMBIENTE CUCINA.

MATERIALS WITH NATURAL APPEAL, FEATURING A ROCK FINISH AND SPECIAL LAMINATE 787. ALTERNATING OPEN AND CLOSED SPACES, CREATED BY COMBINING STORAGE BASE UNITS WITH OPEN UNITS, ARE HIGHLIGHTED BY THE USE OF COLOUR, WHICH ADDS NEW APPEAL AND DYNAMISM TO THE ENTIRE KITCHEN ENVIRONMENT.



Light wood wall-mounted cabinet with yellow interior shelving and a built-in black oven.

Large floor-to-ceiling window providing a view of a green landscape and a white sofa in the living area.

Light wood wall-mounted shelving unit with open shelves for dishes and a yellow interior shelving unit.

Light wood wall-mounted upper cabinets with three black pendant lights hanging below.

Dark wood textured backsplash behind the kitchen counter.

Grey wall-mounted lower cabinets and a central island with a grey countertop and a yellow interior shelving unit.

Two wooden bar stools with black metal bases positioned under the kitchen island.

A framed abstract painting on the dark wood wall.

A long, narrow, patterned rug on the floor in the living area.



Nella pagina precedente: isola centrale in finitura creta, piano snack spessore 6 cm in agglomerato quarzo bianco, pensili e colonne poro registro roccia. Piano di lavoro in laminato speciale 787. I vani a giorno in polimerico lucido ocre caratterizzano l'intera composizione facendo leva oltre che sul colore, su una modularità diversa per ciascun elemento.

On the previous page: a central island unit with creta finish, 6 cm snack top in titan technical agglomerate, and wall units and tall units with roccia register pore finish. Worktop in special laminate 787. Open units in gloss ocre polymer laminate characterize the entire composition, not only focusing on colour but also on different modular options for each unit.





Suddivisione delle funzioni per il piano in finitura laminato speciale 787.

Functions are separated on a worktop with special laminate 787 finish.

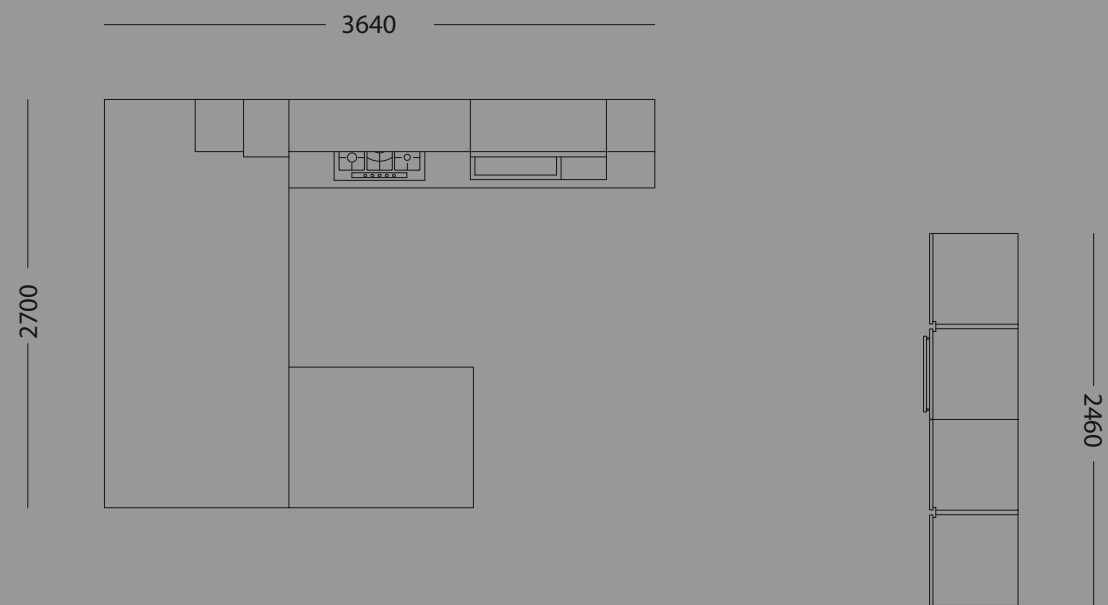

VISIONE
ROVERE CORTECCIA
BISCOTTO



ROUND 05

COMPOSIZIONE FUNZIONALE ED ELEGANTE
SIA NELL'UTILIZZO DEI MATERIALI CHE
NELL'ACCOSTAMENTO DEI COLORI. LE
LINEE DECISE DISEGNATE DA GOLE E
ZOCOLI BRUNITI CONFERISCONO UN TONO
DETERMINATO E CONTEMPORANEO.

*AN ELEGANT AND FUNCTIONAL COMPOSITION
THANKS TO THE MATERIALS USED AND THE
COLOUR COMBINATION. STRIKING LINES FORMED
BY BURNISHED GRIP-RECESSES AND PLINTHS
OFFER DISTINCT, CONTEMPORARY APPEAL.*



Upper kitchen cabinets with a light wood grain finish. On the left, there is a vertical open shelving unit containing glassware and a white bowl. To the right, there is a horizontal open shelving unit containing several white mugs.

A tall, narrow cabinet unit on the right side of the kitchen, featuring white doors and two built-in ovens.

Three wooden stools with metal bases, positioned around the kitchen island.

A large potted plant with green leaves, located in the corner of the kitchen.

A modern pendant light fixture consisting of several white spherical lights hanging from a thin cord.



La finitura visone di basi e colonne, accostata al rovere corteccia di pensili, crea un equilibrato bilanciamento cromatico. Nel dettaglio, elemento a giorno sporgente in finitura biscotto.

The milk finish of the base units, combined with the mahogany oak of wall units and tall units, creates harmoniously balanced colours. Detail of an open unit with biscuit finish and projecting effect.





Il piano materico in rovere corteccia collega i due elementi della cucina, assumendo la doppia veste di piano lavoro e area snack.

A single-material worktop in rovere corteccia links two kitchen elements, doubling up as a worktop and a snack top.

FINITURE FINISHES

I colori delle finiture presenti in questo catalogo sono suscettibili dei procedimenti di stampa. Fa fede il campionario dell'azienda.

The open elements in gloss Ochre polymer laminate can be inserted in tall units and base units or installed as free countertop elements, for a vibrant overall look.

SETA

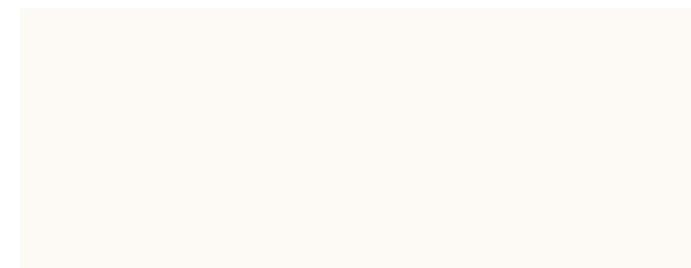

BIANCO



CANAPA

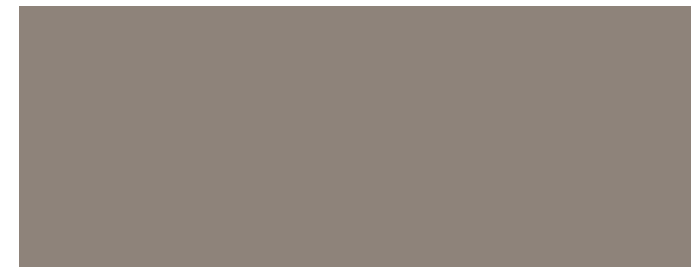

VISONE

LUCIDI

BIANCO

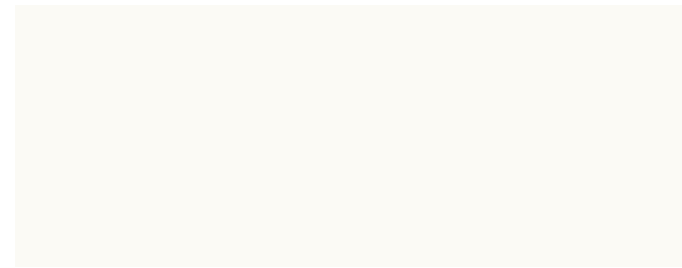

PERLA

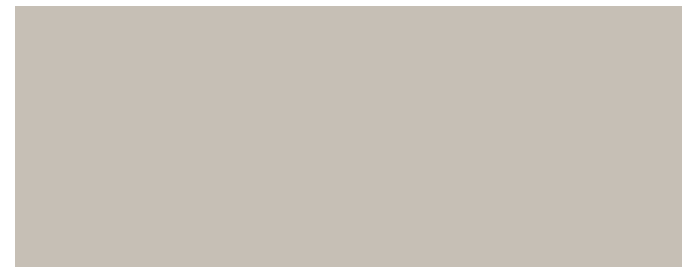

CRETA

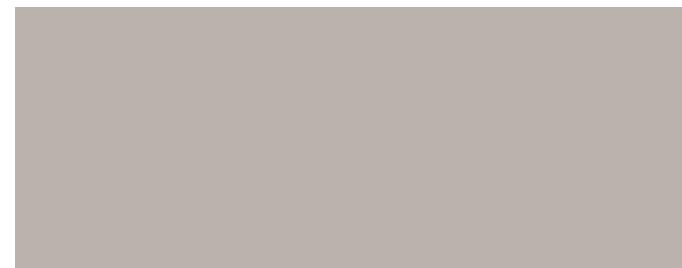

OCRA



PETROLIO

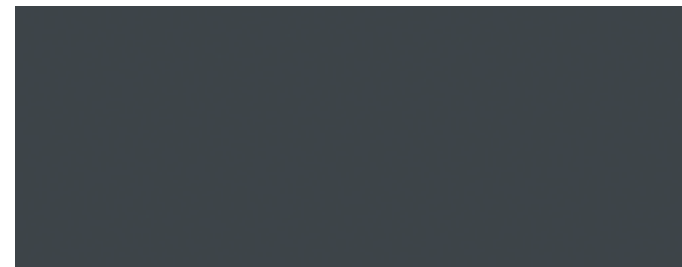

PORO REGISTRO

BIANCO



NEBBIA



SABBIA



ROCCIA



TERRA



PINO



TRANCHÉS

ROVERE
BIANCO



ROVERE
SABBIA



ROVERE
CORTECCIA

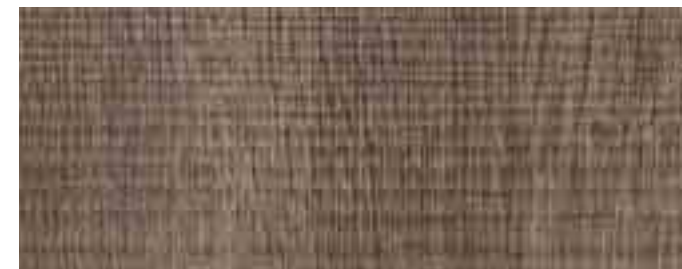

ROVERE
MOGANIO

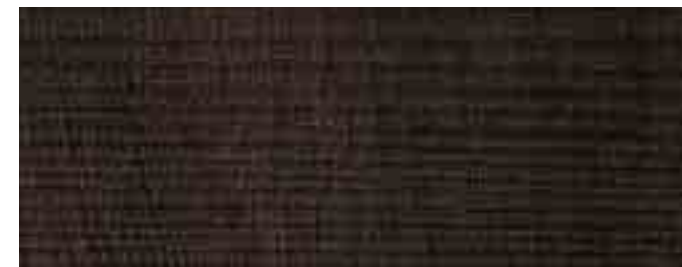



QUALITÀ CERTIFICATA

ARREDO3 s.r.l. Via Moglianese, 23-30037Scorzè (Ve)
Tel. 041.5899111 - Fax 041.5899130
www.arredo3.com - arredo3@arredo3.it



L'Azienda da sempre studia le soluzioni compositive secondo criteri di qualità e funzionalità che distinguono la produzione dell'azienda.

L'Azienda garantisce i suoi materiali rivolgendo la sua attenzione all'ambiente, alla vostra salute e alla loro durata nel tempo.

Azienda con sistema qualità certificato UNI EN ISO 9001:2008.

L'Azienda si riserva di introdurre senza preavviso, eventuali modifiche tecnico-costruttive sul prodotto e sulle composizioni presentate.

The company designs furnishing solutions in line with the principles of quality and functionality that have always been distinctive of its products.

The Company guarantees its materials and their durability, with special attention to the environment and your health.

The Company has the certification UNI EN ISO 9001:2008.

The Company reserves the right to make any technical-manufacturing changes to the product and the suggested arrangements, without prior notice.



ARREDO3 S.r.l.
Via Moglianese, 23
30037 Scorzè (Venezia)
Tel. +39 041 5899111
Fax +39 041 5899130
www.arredo3.it
arredo3@arredo3.it