

PRODUCT SHEET

REF: SHAX

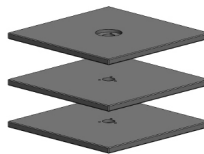

STANDARD WITH GRANITE BASE



DIMENSIONS

Height	302 cm / 119 inch		
	Ø 4,0		
	3 x 4		
	Total weight	300 kg / 661 Lbs	
	Base	260 kg / 573 Lbs	
		28 kg / 61,7 Lbs	
		31 kg / 68,4 Lbs	

PACKAGING

This item is carefully packed per piece.



0,20 m³ - 7,06 Cbft

MAINTENANCE

<http://www.royalbotania.com/maintenance>

POLE

STAINLESS STEEL

Brushed hairline finished Stainless Steel, type AISI304 18/08 with 18% chromium and 8% nickel.

Wall thickness of the Stainless Steel tubes: 2mm.

OPTIONAL: we recommend the electropolishing treatment of the frame if it is to be used in a corrosive environment.

TEAK

We only use carefully selected, fully grown teak, which is harvested in accordance with the strictest environmental standards. The reason for its generally commended durability is the high levels of natural oils it contains. The resulting minimal moisture absorption prevents warping which gives it great stability. Moreover, the wood is extremely resistant to the influences of chemicals, as well as against attacks by vermin.



STAINLESS STEEL - BRUSHED
(optional electropolished)



TEAK

COVER

TEXTILE

Royal Botania fabrics have been woven from mass-coloured acrylic fibre; your guarantee of optimal water- and UV resistance, plus years of comfort.



TEXTILE WU



TEXTILE EU



TEXTILE TU



TEXTILE BU



TEXTILE MU



TEXTILE ROU



TEXTILE FOU



TEXTILE CAU



TEXTILE ZU

BASE

GRANITE

Granite is (after diamond) the hardest stone in the world. Granite combines high scratch resistance with minimal porosity.



GRANITE - PEARL GREY

Optional mobile base

PRODUCT SHEET

REF: MOB X

Royal Botania^{.com}
Belgian outdoor luxury

DIMENSIONS

Width 90 cm / 35 inch
Depth 90 cm / 35 inch
Height 12 cm / 5 inch



188 kg / 415 Lbs

PACKAGING

This item is carefully packed per piece.



MAINTENANCE

<http://www.royalbotania.com/maintenance>

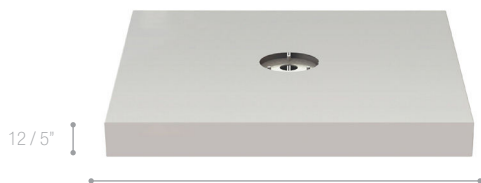

☑ 90 x 90

☑ 35" x 35"

BASE

STAINLESS STEEL

Brushed hairline finished Stainless Steel, type AISI304 18/08 with 18% chromium and 8% nickel.

Wall thickness of the Stainless Steel tubes: 2mm.

OPTIONAL: we recommend the electropolishing treatment of the frame if it is to be used in a corrosive environment.



STAINLESS STEEL - BRUSHED



STAINLESS STEEL - ELECTROPOLISHED (optional)

COATED ALUMINUM

Aluminium is a non-ferrous metal, which combines great mechanical rigidity with light weight; this makes it especially suitable for making furniture. If treated correctly it has a good resistance to corrosion. One of the treatments is powder coating. After a chemical pre-treatment an epoxy powder is applied statically and baked.



COATED ALUMINUM - WHITE



COATED ALUMINUM - CAPPUCCINO



COATED ALUMINUM - BLACK

- ☑ Stainless steel or coated aluminum cover
- ☑ Nylon wheels and detachable handle for moving around on the terrace
- ☑ Concrete weights included

