



The photograph may not match the reference exactly. Please read the product description to identify the finish.

**TECHNICAL CHARACTERISTICS**

Type:	Wall fixture
IP Protection degrees:	IP20
Lampholder:	1 x E27
Power (W):	E27 MAX 60W
Total power consumption (W):	60
Voltage / Frequency:	220-240V/50-60Hz
Warranty (Years):	2
Units per box:	4
Net Weight (Kg):	0.36
EAN:	8435381401245,00



Download photometric file .ldt /.ies

**MATERIALS / FINISHES**

**Structure material:** Steel

**Structure finish:** Satin nickel

## PAN-175-14



**Structure material:** Steel  
**Structure finish:** White  
**Diffuser material:** Fabric shade  
**Diffuser finish:** White

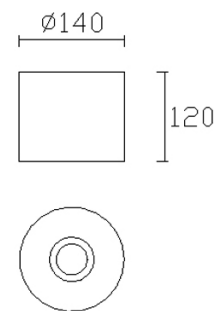

IP20

## PAN-175-BY



**Structure material:** Steel  
**Structure finish:** White  
**Diffuser material:** Fabric shade  
**Diffuser finish:** Sandblasted

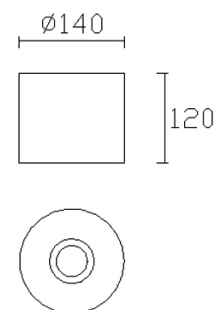

IP20

## PAN-178-14



**Structure material:** Steel  
**Structure finish:** White  
**Diffuser material:** Fabric shade  
**Diffuser finish:** White

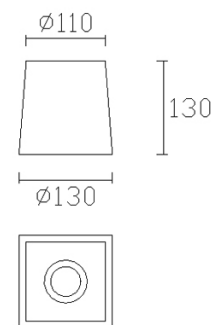

IP20

## PAN-178-BY



**Structure material:** Steel  
**Structure finish:** White  
**Diffuser material:** Fabric shade  
**Diffuser finish:** Sandblasted

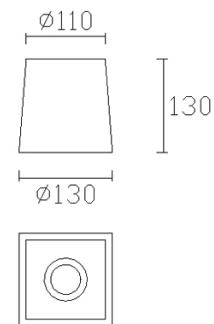

IP20

**PAN-186-20**



**Structure material:** Steel  
**Structure finish:** White  
**Diffuser material:** Fabric shade  
**Diffuser finish:** Beige

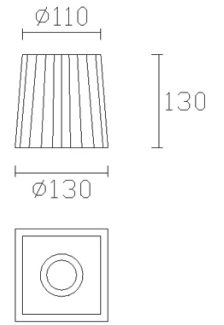

IP20

**PAN-179-14**



**Structure material:** Steel  
**Structure finish:** White  
**Diffuser material:** Fabric shade  
**Diffuser finish:** White

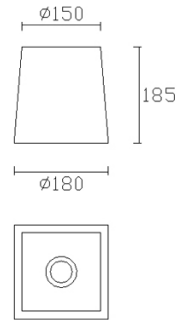

IP20

**PAN-179-BY**



**Structure material:** Steel  
**Structure finish:** White  
**Diffuser material:** Fabric shade  
**Diffuser finish:** Sandblasted

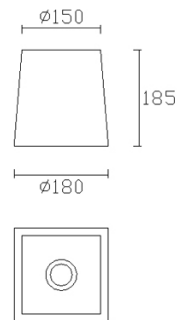

IP20

**PAN-187-20**



**Structure material:** Steel  
**Structure finish:** White  
**Diffuser material:** Fabric shade  
**Diffuser finish:** Beige

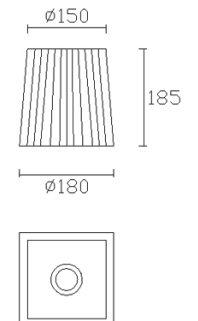

IP20

PAN-176-14

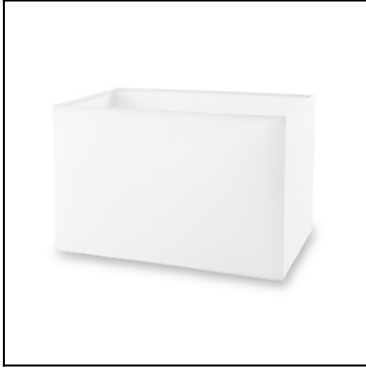

**Structure material:** Steel  
**Diffuser material:** Fabric shade  
**Diffuser finish:** White

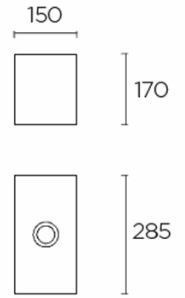

PAN-176-BY



**Structure material:** Steel  
**Diffuser material:** Fabric shade  
**Diffuser finish:** Sandblasted

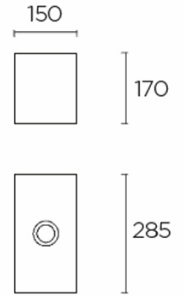

PAN-177-14



**Structure material:** Steel  
**Diffuser material:** Fabric shade  
**Diffuser finish:** White

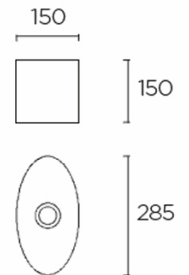

PAN-177-BY



**Structure material:** Steel  
**Diffuser material:** Fabric shade  
**Diffuser finish:** Sandblasted

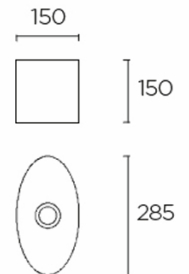

PAN-198-V7



**Structure material:**

Steel

**Structure finish:**

Brown

**Diffuser material:**

PVC

**Diffuser finish:**

Antique copper

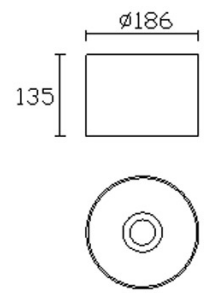

IP20

<b>Luminaire</b>		<b>Measur.</b>		<b>Lamp</b>		
Code	05-1567	Code	05-1567	Code	INCANDESCENT	
Name	WALL LIGHT	Name	WALL LIGHT	Number	1	
Line	LYON	Date	16-11-2013	Position		
Efficiency	38.70%	Coordinate system	CG	Total Flux	710.00 lm	
Maximum value	53.21 cd	Position	C=30.00 G=75.00	Asymmetrical		
Rectangular Luminaire	Length	1 mm	Width	1 mm	Height	1 mm
Rectangular Luminous Area	Length	1 mm	Width	1 mm	Height	0 mm
Horizontal Luminous Area	0.000001 m2	Emitting area on Plane 180°		0.000000 m2		
Emitting area on Plane 0°	0.000000 m2	Emitting area on Plane 270°		0.000000 m2		
Emitting area on Plane 90°	0.000000 m2	Glare area at 76°		0.000000 m2		
Symmetry Type	Asymmetrical	Maximum Gamma Angle		180		
Measurement Distance	0.00	Measurement Flux		710.00 lm		
Operator		Source voltage				
Temperature	25.00 °C	Source current				
Humidity	60.00 %	Photocell				
Notes						

Luminaire Lamps						
Line	Code	Name	Flux [lm]	Pow. [W]	Q.ty	
IESNA-1995	INCANDESCENT	E27-60W - 57.10 W	710.00	57.10	1	
C.I.E.	16 44 73 58 39	D DIN 5040				C11
F UTE	--	B NBN				BZ 10 / 1 / BZ 9

1mm x 1mm

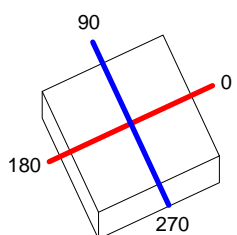

**C Halfplanes**

180.0 — 0.0

270.0 — 90.0

ULOR 16.17 %

DLOR 22.53 %

RN 41.79 %

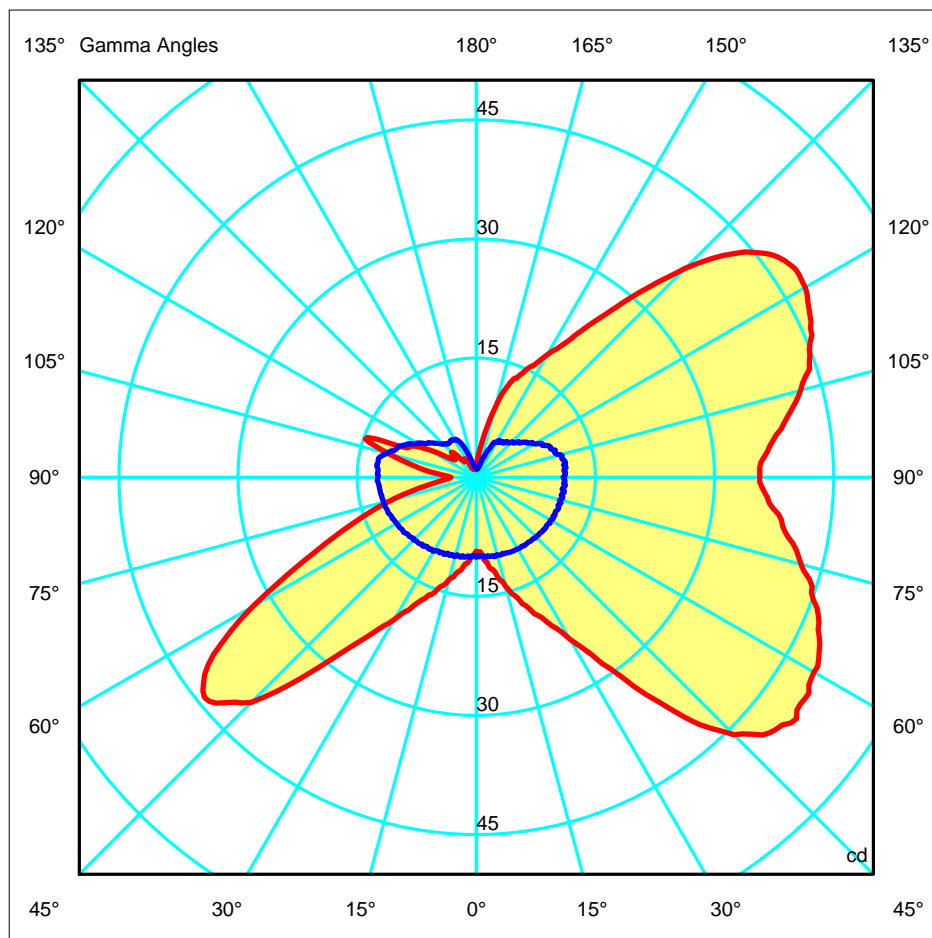



**1**

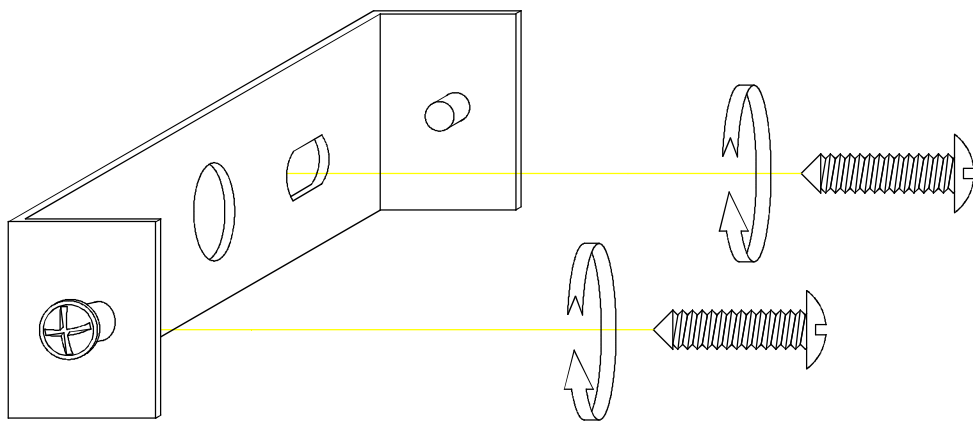
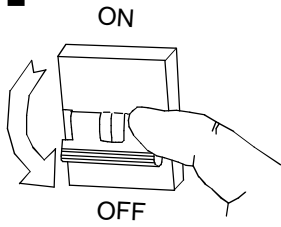

**2**

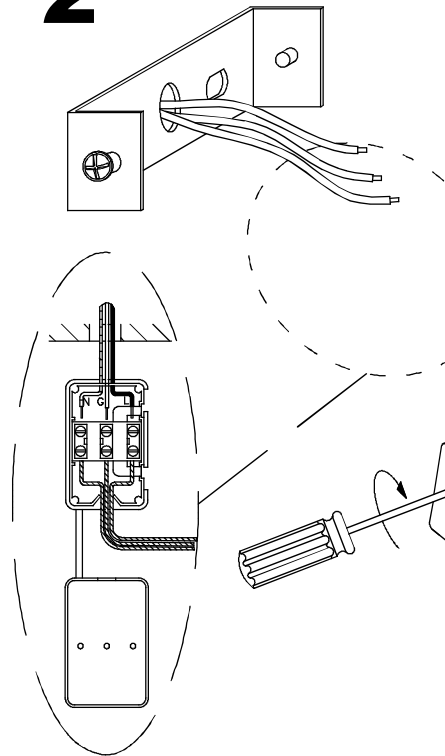

**3**

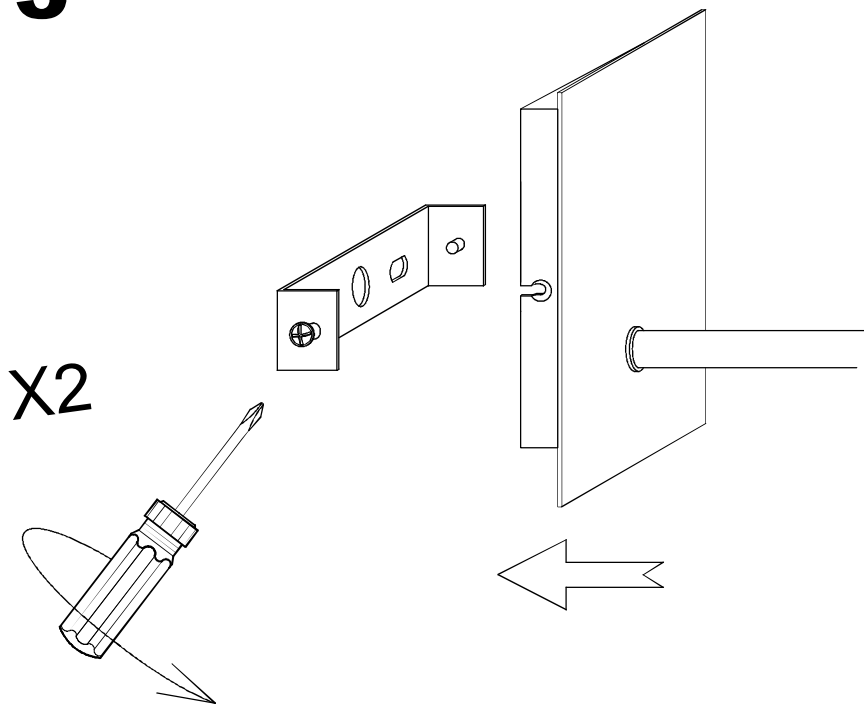

**4**

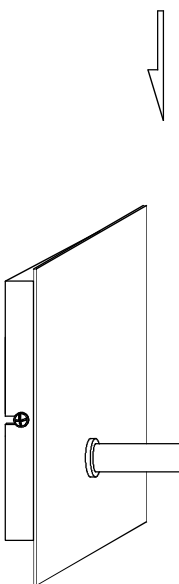

**5**

