

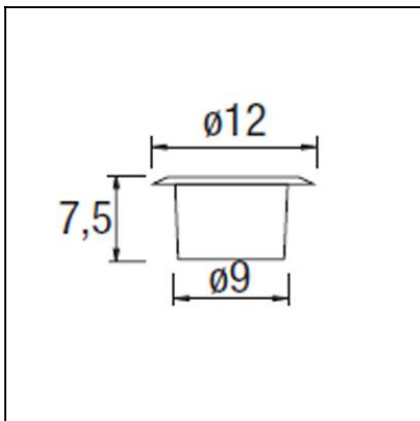

The photograph may not match the reference exactly. Please read the product description to identify the finish.



#### TECHNICAL CHARACTERISTICS

|                              |               |
|------------------------------|---------------|
| Type:                        | Downlight     |
| IP Protection degrees:       | IP67          |
| IK Protection degrees:       | IK08          |
| Lampholder:                  | 1 x GX53      |
| Power (W):                   | GX53 MAX 9W   |
| Total power consumption (W): | 9             |
| Voltage / Frequency:         | 230V/50-60Hz  |
| Warranty (Years):            | 2             |
| Units per box:               | 8             |
| Net Weight (Kg):             | 0.6           |
| EAN:                         | 8435111044544 |



#### MATERIALS / FINISHES

**Structure material:** Stainless steel AISI304  
Injected aluminium

**Structure finish:** Polished

**Diffuser material:** Glass

**Diffuser finish:** Tempered

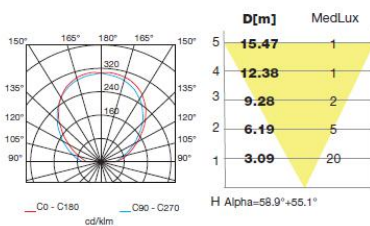

Download photometric file .ldt /.ies

71-9450-CA-CA



**Structure material:** Stainless steel AISI316  
**Structure finish:** Polished

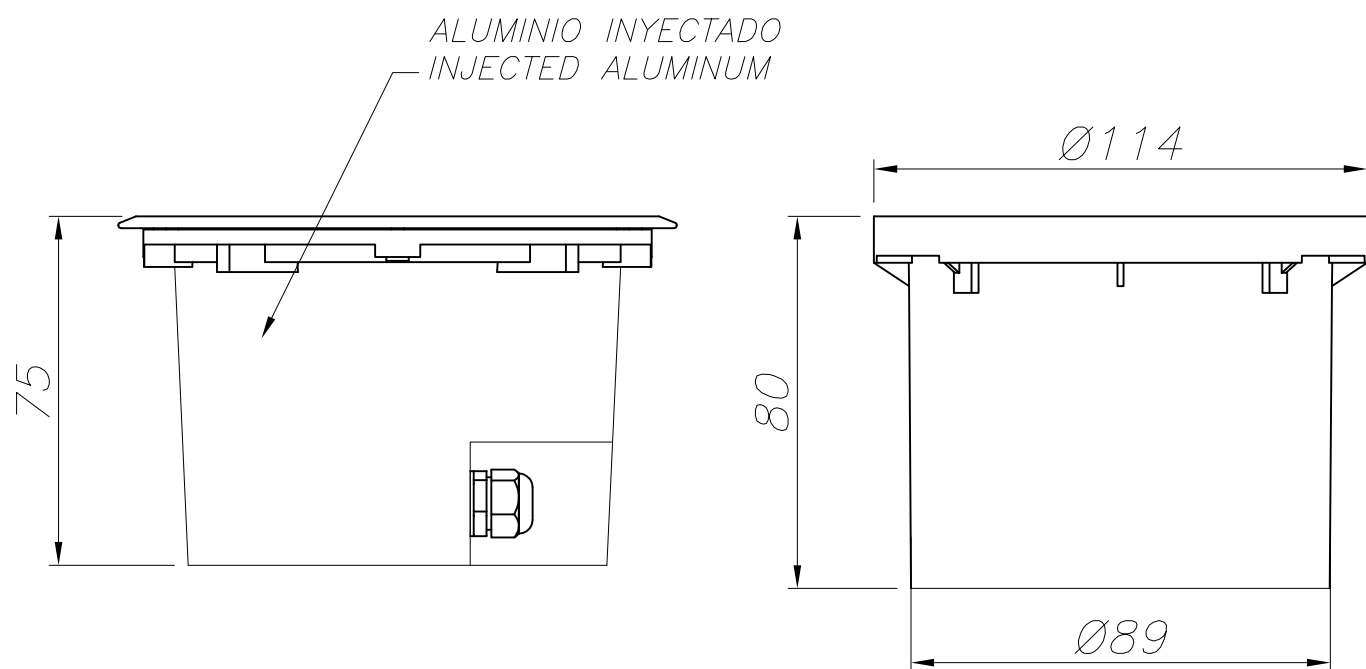

CAJA DE EMPOTRAR  
FLUSH FITTING BOX

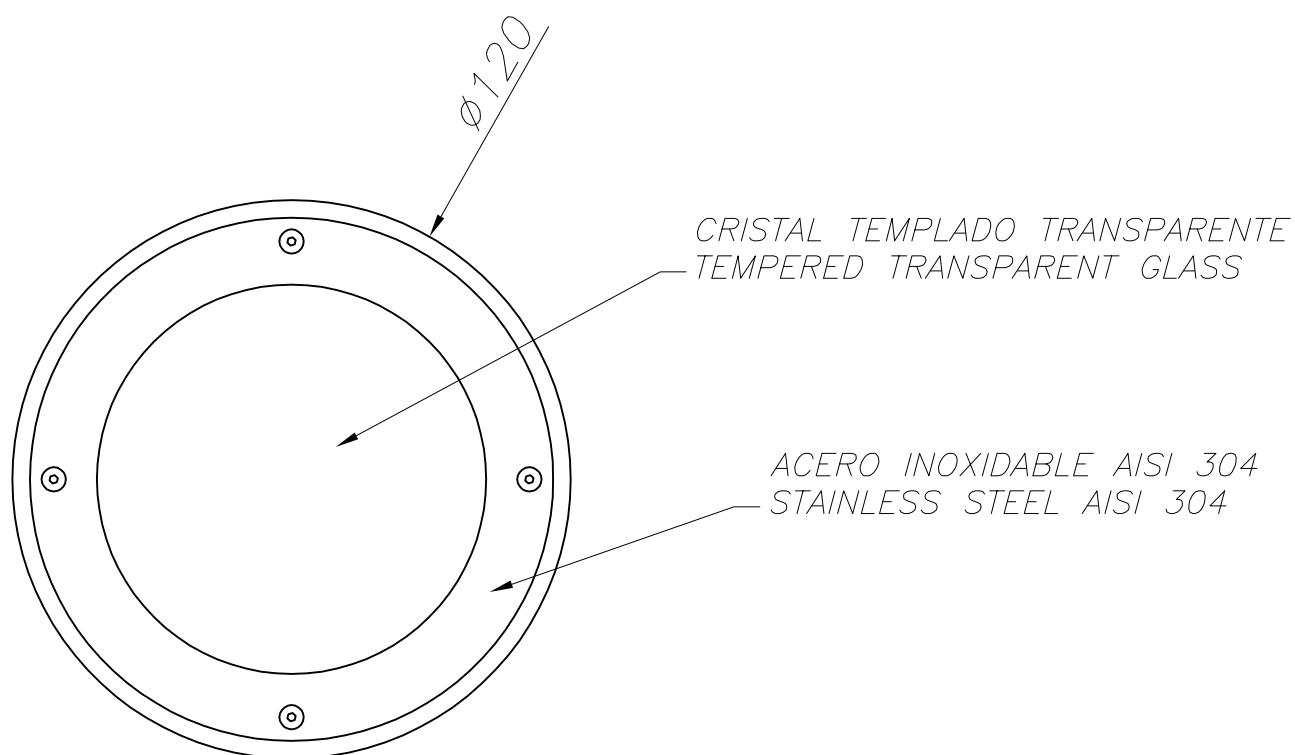

①

10l / 15min

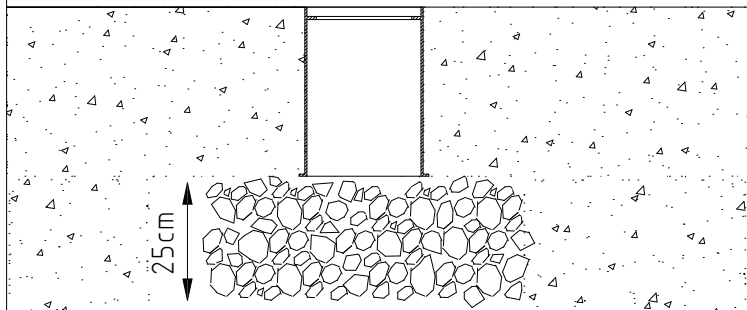

②

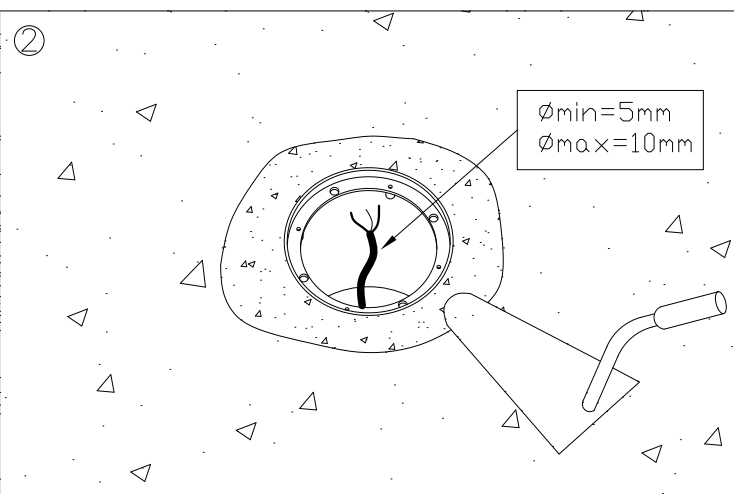

③

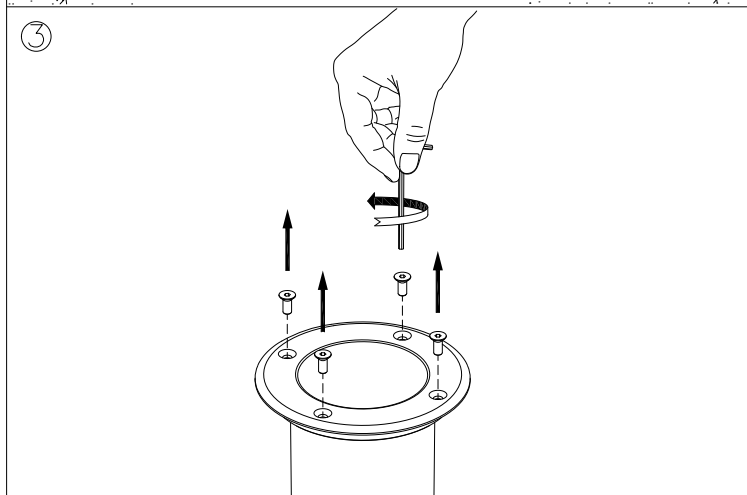

④

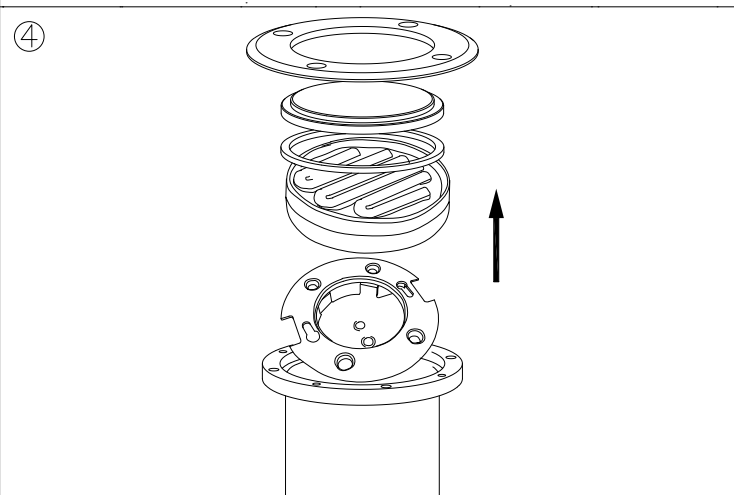

⑤

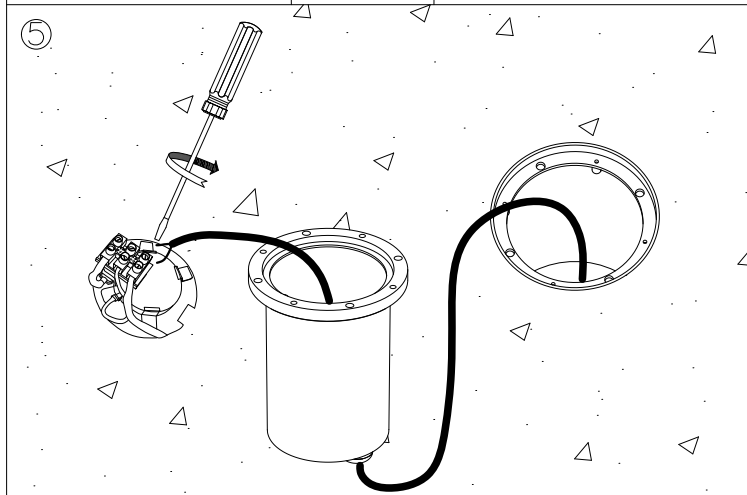

⑥

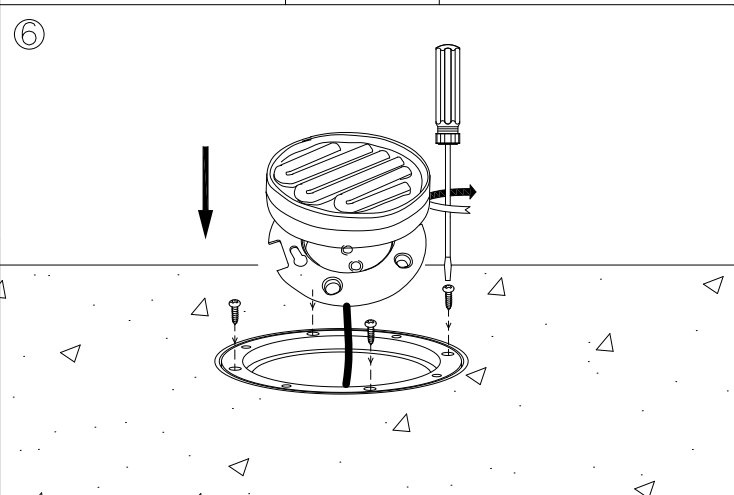

⑦

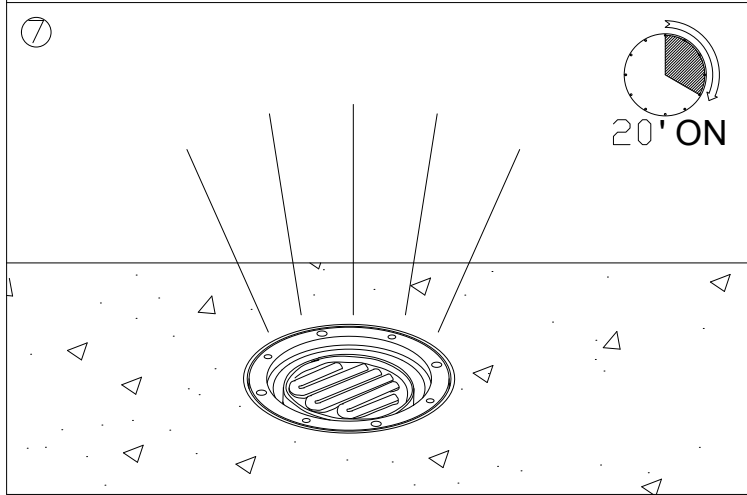

⑧

