

Sedia con struttura in legno laccato lucido nero beluga.
 Chair with wooden structure in nero beluga shiny lacquered finish.
 Stuhl aus Holz, glänzend lackiert nero beluga.
 Chaise avec structure en bois laqué nero beluga brillant.

MISURE STANDARD/STANDARD SIZE/STANDARDGRÖSSEN/MESURES STANDARDS

38 x 46 x 90 h

Tessuto / Fabric / Stoff / Tissu AMSTERDAM (Extra)
 Velluto / Velvet / Samt / Velours

Pelle / Leather / Leder / Cuir
 CAT. C - NABUK

COLORATA - DUNE
 (minimo 2 sedie / minimum 2 chairs / mindeste 2 Stühle / 2 chaises minimum)

Tessuto cliente** / C.O.M.** / Kundestoff** / Tissu du client**

FINITURE OPZIONALI/OPTIONAL FINISH/SONDER-AUSFÜHRUNGEN/FINITIONS EN OPTION

- Struttura in Ebano laccato lucido oppure in ottone (104M) o ottone dark (105M) satinato
 Structure in shiny Ebony or in satin finish: brass (104M), dark brass (105M), / Struktur aus glänzendem Ebenholz oder Ausführung satiniert Messing (104M), dark Messing (105M) / Structure en Ebène brillant ou finition satiné: laiton (104M), laiton dark (105M).

- Trapuntatura DIAMOND
 DIAMOND quilting / DIAMOND Steppung / capitonnage DIAMOND

- Trapuntatura SAN MARCO
 SAN MARCO quilting / SAN MARCO Steppung / capitonnage SAN MARCO

**Verificare quantitativo e tipologia di materiale / **Check about quantity and type of material / **Menge und Art des Materials sind zu prüfen / **Vérifier quantité et typologie de matériau

0,44 8

SEDUTE
 CHAIRS
 STÜHLE
 CHAISES

NEW YORK 2

DISEGNO SACHA LAKIC

mc kg

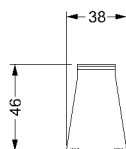
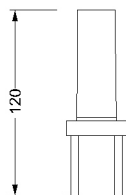
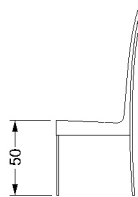

Sedia con struttura in legno laccato lucido nero beluga.
 Chair with wooden structure in nero beluga shiny lacquered finish.
 Stuhl aus Holz, glänzend lackiert nero beluga.
 Chaise avec structure en bois laqué nero beluga brillant.

MISURE STANDARD/STANDARD SIZE/STANDARDGRÖSSEN/MESURES STANDARDS

38 x 46 x 120 h

Tessuto / Fabric / Stoff / Tissu AMSTERDAM (Extra)
 Velluto / Velvet / Samt / Velours

Pelle / Leather / Leder / Cuir
 CAT. C - NABUK

COLORATA - DUNE
 (minimo 2 sedie / minimum 2 chairs / mindeste 2 Stühle / 2 chaises minimum)

Tessuto cliente** / C.O.M.** / Kundestoff** / Tissu du client**

FINITURE OPZIONALI/OPTIONAL FINISH/SONDER-AUSFÜHRUNGEN/FINITIONS EN OPTION

• Struttura in Ebano laccato lucido oppure in ottone (104M) o ottone dark (105M) satinato
 Structure in shiny Ebony or in satin finish: brass (104M), dark brass (105M), / Struktur aus glänzendem Ebenholz oder Ausführung satiniert Messing (104M), dark Messing (105M) / Structure en Ebène brillant ou finition satiné: laiton (104M), laiton dark (105M).

• Trapuntatura DIAMOND
 DIAMOND quilting / DIAMOND Steppung / capitonnage DIAMOND

• Trapuntatura SAN MARCO
 SAN MARCO quilting / SAN MARCO Steppung / capitonnage SAN MARCO

**Verificare quantitativo e tipologia di materiale / **Check about quantity and type of material / **Menge und Art des Materials sind zu prüfen / **Vérifier quantité et typologie de matériau

0,53 15

NEW YORK XL

DISEGNO REFLEX

mc kg

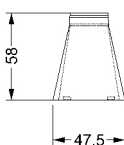
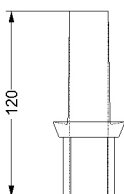
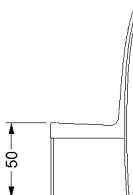

Sedia con struttura in legno laccato lucido nero beluga.
 Chair with wooden structure in nero beluga shiny lacquered finish.
 Stuhl aus Holz, glänzend lackiert nero beluga.
 Chaise avec structure en bois laqué nero beluga brillant.

MISURE STANDARD/STANDARD SIZE/STANDARDGRÖSSEN/MESURES STANDARDS

47,5 x 58 x 120 h

Tessuto / Fabric / Stoff / Tissu AMSTERDAM (Extra)
 Velluto / Velvet / Samt / Velours

Pelle / Leather / Leder / Cuir
 CAT. C - NABUK

COLORATA - DUNE
 (minimo 2 sedie / minimum 2 chairs / mindeste 2 Stühle / 2 chaises minimum)

Tessuto cliente** / C.O.M.** / Kundestoff** / Tissu du client**

FINITURE OPZIONALI/OPTIONAL FINISH/SONDER-AUSFÜHRUNGEN/FINITIONS EN OPTION

• Struttura in Ebano laccato lucido oppure in ottone (104M) o ottone dark (105M) satinato
 Structure in shiny Ebony or in satin finish: brass (104M), dark brass (105M), / Struktur aus glänzendem Ebenholz oder Ausführung satiniert Messing (104M), dark Messing (105M) / Structure en Ebène brillant ou finition satiné: laiton (104M), laiton dark (105M).

• Trapuntatura DIAMOND
 DIAMOND quilting / DIAMOND Steppung / capitonnage DIAMOND

• Trapuntatura SAN MARCO
 SAN MARCO quilting / SAN MARCO Steppung / capitonnage SAN MARCO

**Verificare quantitativo e tipologia di materiale / **Check about quantity and type of material / **Menge und Art des Materials sind zu prüfen / **Vérifier quantité et typologie de matériau

0,64 17